

Multimedia Mode

Multimedia mode only applies to Media Player and iTunes running on Windows..

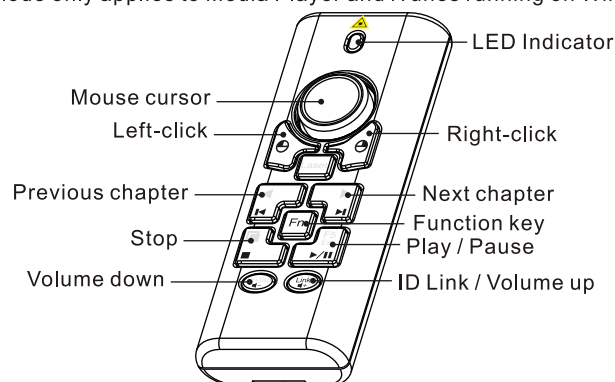

Key	Function	How to operate
LED Indicator	Mode indicator	Blue - Multimedia mode
	Mouse movement	Push to move the mouse cursor
	Left-click	Mouse left-click function
	Right-click	Mouse right-click function
Laser	N/A	Laser function only works in Presentation mode
	Previous chapter	Click to return to the previous chapter
	Next chapter	Click to proceed to the next chapter
Fn	Change mode	Press and hold for three seconds to change to Presentation mode
	Play / Pause	Click to start playback. Click again to pause playback Click again to resume playback
	Stop	Click to stop playback
	Volume down	Click to decrease computer's system volume
ID Link	1. Change to a new ID 2. Volume up	1. See ID Link Process introduction 2. Click to increase computer's system volume

Specifications

Frequency range: 2400~2483MHz
 Remote range: Approx. 100 feet
 Operating voltage: Remote control : 2.4V~3.3V ; Laser : 2.6V~3.3V
 Power: AAA battery x 2
 Power consumption: Normal operation < 5mA ; Laser operation < 20mA ; Sleep < 10uA
 Output power: Under 1mW
 Presenter dimension: 105(l) x 40(w) x 20(h) mm
 Receiver dimension: 49(l) x 16(w) x 3.5(h) mm
 Presenter weight: Approx. 63.6 grams (include batteries; excluding USB receiver)
 Receiver weight: Approx. 2.6 grams
 Operating temperature : 0°C(32°F)~60°C(140°F)
 Operating humidity(non-condensing) : 10%~85% RH
 Laser: Semiconductor laser (λ = 650 nm), emission duration: continuous
 Laser output power: Max.0.95 mW

Note: Design and specifications are subject to change without notice.



"Technology on the move!"

Kanguru Presenters Mouse (2.4GHz)

Please be aware of the following points before using the Kanguru Presenters Mouse

Copyright © 2011 Kanguru Solutions. All rights reserved.

Windows2000®, WindowsXP®, WindowsVista™, Windows7™, Microsoft Media Player and PowerPoint are registered trademarks of Microsoft Inc. iTunes and Mac OS is a registered trademarks of Apple Computer, Inc. All other brands or product names are trademarks of their respective companies or organizations.

Customer Service

To obtain service or technical support for your system, please contact Kanguru Solutions Technical Support Department at 508-376-4245, or visit www.Kanguru.com for web support.

Legal notice

Kanguru Solutions will not be held responsible for any illegal use of this product nor any losses incurred while using this product. The user himself is fully responsible for any illegal actions taken. Legal terms and conditions are available at www.kanguru.com. Please review and agree before use. Thank you.

Export Law Compliance

Regardless of any disclosure made to Kanguru Solutions pertaining to the ultimate destination of the specific Kanguru product, you warrant that you will not export, directly or indirectly, any Kanguru product without first obtaining the approval of Kanguru Solutions and the appropriate export license from the Department of Commerce or other agency of the United States Government. Kanguru Solutions has a wide range of products and each product family has different license requirements relative to exports. Kanguru Solutions will not be held responsible for any illegal use of this product nor any losses incurred while using this product. The user himself is fully responsible for any illegal actions taken. Legal terms and conditions are available at www.kanguru.com. Please review and agree before use. Thank you.

IMPORTANT SAFETY AND HEALTH INFORMATION

WARNING! RISK OF INJURY!

Laser beam can cause permanent damage to eyes. Do not look into the laser beam or shine the laser beam into your eyes, other peoples' eyes, or pet's eyes.

WARNING! RISK OF INJURY!

Keep this device away from Children. This is a working tool, not a toy or entertainment device. It should only be used by adults.

FEDERAL COMMUNICATIONS COMMISSION

This device complies with Part 15 of the FCC Rules. Operation is subject to the following two conditions: (1) this device may not cause harmful interference, and (2) this device must accept any interference received, including interference that may cause undesired operation.

NOTE

This equipment has been tested and found to comply with the limits for a Class B digital device, pursuant to Part 15 of the FCC Rules. These limits are designed to provide reasonable protection against harmful interference in a residential installation. This equipment generates, uses and can radiated radio frequency energy and, if not installed and used in accordance with the instructions, may cause harmful interference to radio communications. However, there is no guarantee that interference will not occur in a particular installation. If this equipment does cause harmful interference to radio or television reception, which can be determined by turning the equipment off and on, the user is encouraged to try to correct the interference by one or more of the following measures:

- Reorient or relocate the receiving antenna.
- Increase the separation between the equipment and receiver.
- Connect the equipment into an outlet on a circuit different from that to which the receiver is connected.
- Consult the dealer or an experienced radio/TV technician for help.

Changes or modifications not expressly approved by the party responsible for compliance could void the user's authority to operate the equipment.

This product meets all the standards and requirements of the European Directives.

This product meets the RoHS guidelines for electronic components, and hardware. This complies with the requirements of the EU directive for banned substances.

For more information regarding compliances, please contact Kanguru Solutions.

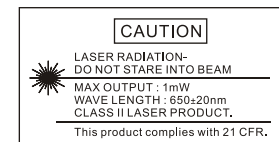

Chapter 1: Introduction

Package Contents

- ✓ Kanguru Presenters Mouse with USB Receiver (attached to the back of device)
- ✓ AAA Battery x 2
- ✓ User's Manual

System Requirements

- Operating Systems : Windows® 2000/XP/Vista/7 or Mac OS® 10.3 or later
- An available USB port

Chapter 2 Using Your Kanguru Presenters Mouse

Before you start using your Kanguru Presenters Mouse, please familiarize yourself with the device as well as the different operating modes and functions.

Connecting the USB receiver

Remove the USB receiver from the back of the Presenters Mouse and plug it into an available USB port. To remove the USB receiver, pull up on the USB receiver as in the following figure then lift the receiver out.

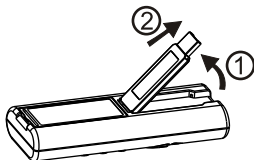

Insert the receiver into a USB port on your computer. The operating system will identify the new hardware and will install the necessary driver automatically. Follow the on screen instructions to complete the installation.

Reattaching the USB receiver

To reattach the USB receiver, insert the bottom of the USB receiver with the label side facing up. Press the USB receiver down firmly into its compartment until it clicks into place.

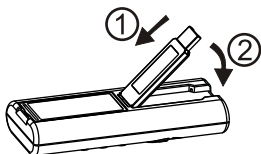

Operation Modes

There are two main operation modes:

- Presentation Mode
- Multimedia Mode

The wireless mouse buttons (cursor, right-click, left-click) work in both modes. However other buttons may function one way in Presentation Mode and another way in Multimedia Mode. Please make sure you are in the right mode when using the device.

Note: To determine what mode your Presenters Mouse is currently set in, check the Mode Indicator LED located on the front, at the top of the Presenters Mouse. When the Mode Indicator LED is off, the Presenters Mouse is in Presentation Mode. When the Mode Indicator Light is blue, the Presenters Mouse is in Multimedia Mode.

The buttons on the Kanguru Presenters Mouse have functions written in two different colors. Each button may have multiple functions:

- **Off** - Presentation Mode normal functions
- **Red** - Presentation Mode special functions
- **Blue** - Multimedia Mode functions

Note: More information on the functions are provided on next page.

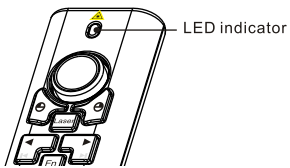

ID Link Process

You should only change your device's radio frequency ID if:

- More than one Kanguru Presenters Mouse is being used in the same area at the same time.
- There is interference being caused by another 2.4GHz device.

To change your device's ID:

1. Press the **Link** button on the USB receiver. The red LED on the receiver will light up.
2. Press and hold the **FN** and **Link** buttons on the Presenter Mouse simultaneously until the red LED on the receiver blinks.
3. Once the red LED on receiver becomes blinking, the pairing is completed.

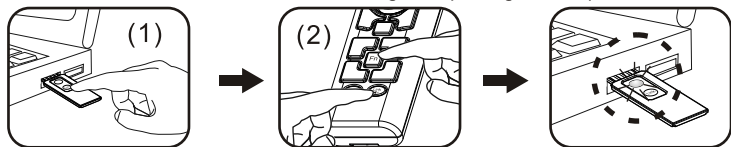

Presentation Mode

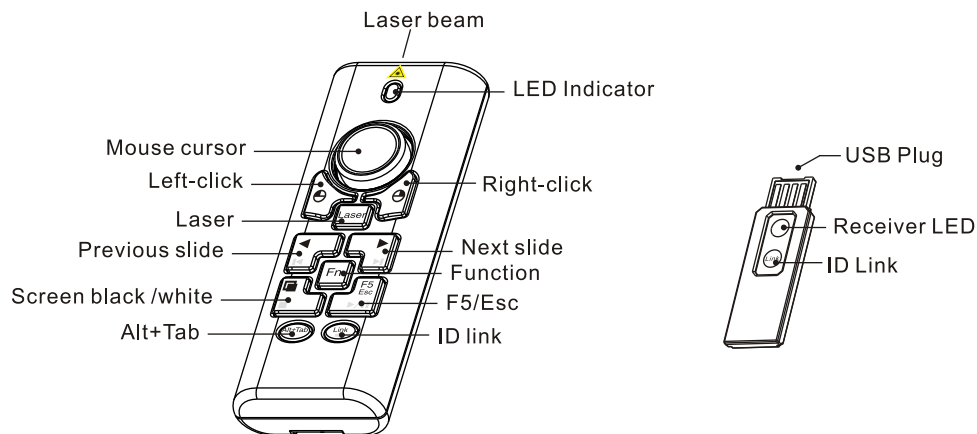

Key	Function	How to operate
LED Indicator	Mode indicator	<ul style="list-style-type: none"> • Off - Presentation mode • Blinking red - Laser function enabled
	Mouse movement	Push to move the mouse cursor
	Left-click	Mouse left-click function
	Right-click	Mouse right-click function
Laser	<ol style="list-style-type: none"> 1. Turn laser function on/off 2. Shoot laser beam 	<ol style="list-style-type: none"> 1. Press and hold the Laser and Fn button simultaneously for two seconds to turn the laser function on/off. 2. When the laser function is on, press the Laser button to shoot the laser beam.
	Previous slide	Click to return to the previous slide
	Next slide	Click to proceed to the next slide
Fn	Change mode	Press and hold for three seconds to change to Multimedia mode
	Black screen/White screen	<ol style="list-style-type: none"> 1. Press once to turn presentation screen black. Press again to return to presentation 2. Press and hold for one second to turn presentation screen white. Press again to return to presentation
F5 Esc	Start / Exit slideshow	<ul style="list-style-type: none"> • Click to start slideshow • Press and hold for one second to exit slideshow
Alt+Tab	Switch window	Press and hold the Fn button and then press the Alt+Tab button to switch between open windows Note: This function is not available on Mac OSX
ID Link	Change to a new ID	See ID Link Process introduction